

HYDROFLEX 10 SEPARATION SHEET OR OTHER APPROVED PROTECTION

METAL FLASHING, STONE CLADDING OR OTHER APPROPRIATE EXTERIOR FINISH SYSTEM

FLEX-FLASH F REINFORCEMENT

APPROPRIATE SURFACING—STONE OR PAVER BALLAST, HYDROGUARD, GARDEN ROOF

MONOLITHIC MEMBRANE 6125-FR

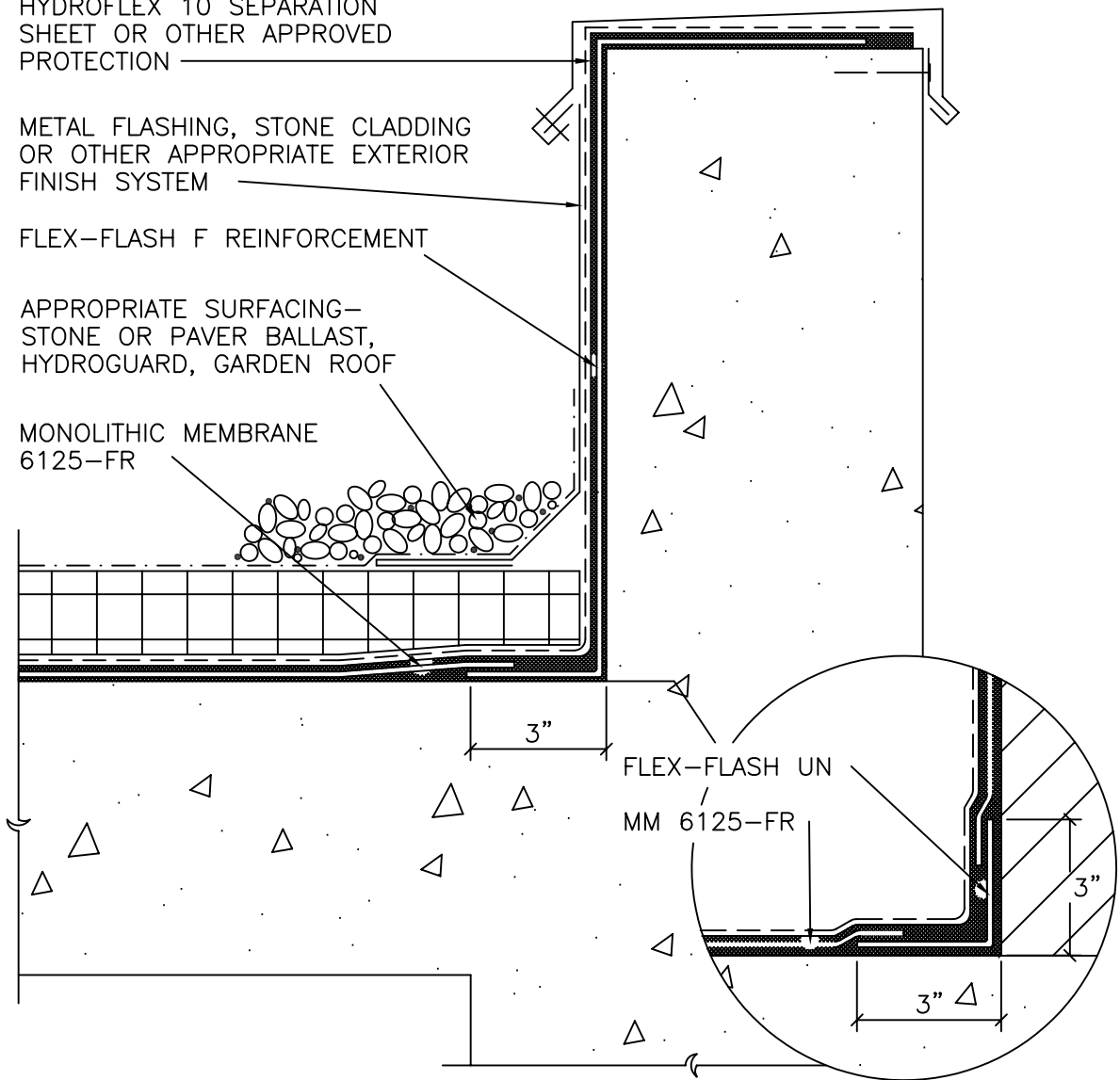

NOTES: MONOLITHIC MEMBRANE 6125 CAN BE USED TO FLASH PERIMETER PARAPET/CURB DETAILS BUT MUST NOT BE LEFT EXPOSED.

FLEX-FLASH F MAY BE USED AT ALL CONCRETE-TO-CONCRETE AND CONCRETE-TO-CONCRETE BLOCK TRANSITIONS. FLEX-FLASH UN MUST BE USED AT ALL OTHER TRANSITIONS (i.e., CONC.-TO-GYP. BOARD, GYP. BOARD-TO-GYP. BOARD, ETC.).

PARAPETS/CURBS COMPOSED OF CONCRETE BLOCK (CMU) MUST BE FLASHED WITH MM 6125-FR (FABRIC REINFORCED) MEMBRANE. (SEE INSET DETAIL)



Monolithic Membrane  
6125-FR  
ROOFING SYSTEMS

AMERICAN HYDROTECH, INC.

TYPICAL PARAPET COVERED FLASHING CONDITIONS

3"=1'-0"

R-11A