

REFER TO HYDROTECH'S GUIDELINE ROOFING AND WATERPROOFING DETAILS FOR SUGGESTED TERMINATIONS, FLASHINGS AND DETAILING SPECIFICS.

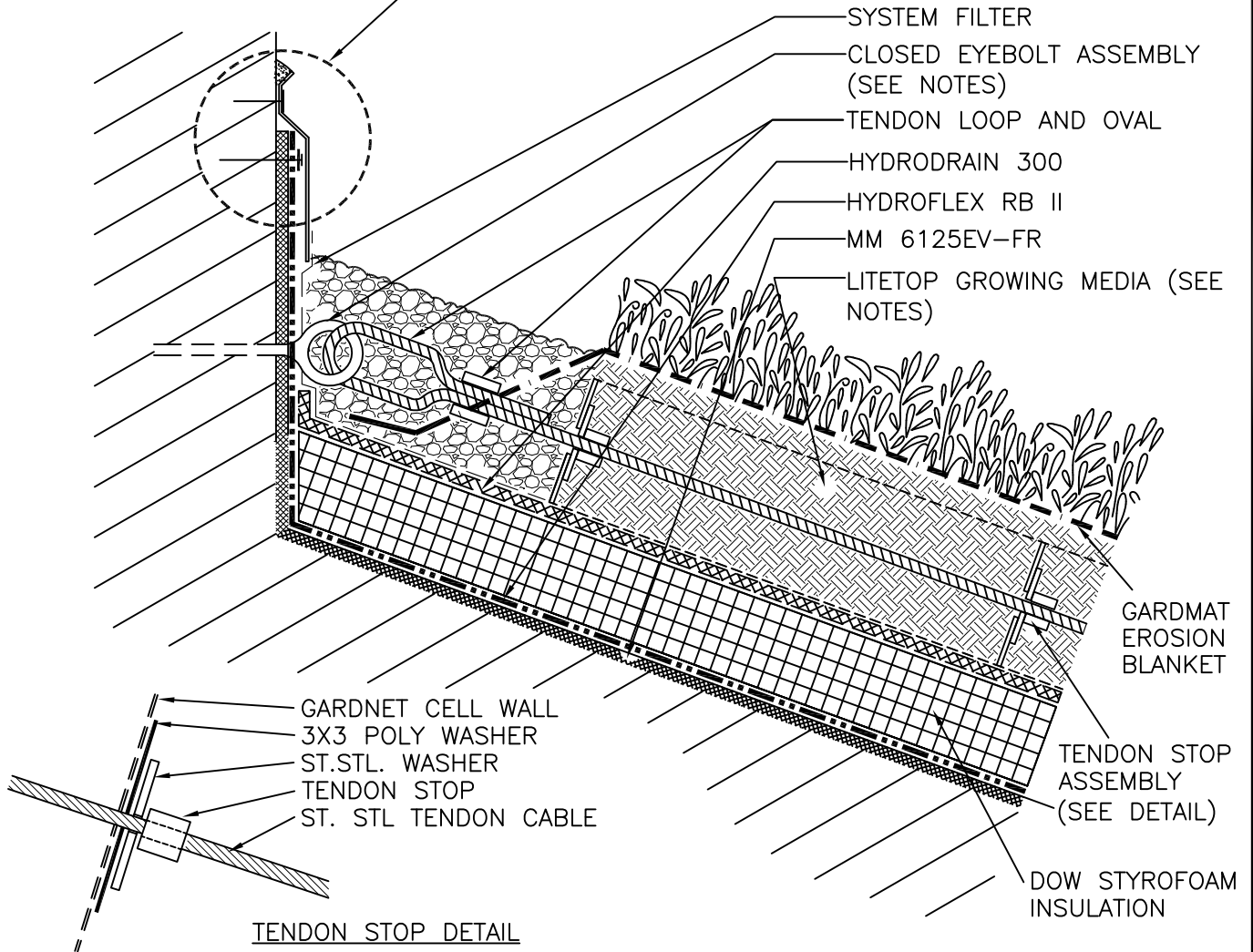

**NOTES:**

- EYEBOLT ASSEMBLY PULL OUT STRENGTH AND METHOD OF ATTACHMENT TO STRUCTURE MUST BE DETERMINED AND VERIFIED BY PROJECT ENGINEER.
- IF DOW STYROFOAM INSULATION IS NOT INSTALLED, HYDRODRAIN 302 SHALL BE PLACED ON TOP OF THE HYDROFLEX RB II.
- NUMBER OF STOPS AND NUMBER AND LENGTH OF REQUIRED TENDONS IS DETERMINED BY MEDIA DEPTH AND DEGREE & LENGTH OF SLOPE.
- LITETOP GROWING MEDIA IS REQUIRED FOR ALL GARDNET INSTALLATIONS. NO SUBSTITUTIONS ARE ALLOWED.
- UPPER LAYER OF GARDNET CELLS MUST BE OVERFILLED WITH LITETOP SOIL BY 1/2"–1".
- GARDMAT EROSION MAT SHALL BE INSTALLED WHEN PLANTING PLUGS. NO GARDMAT IS REQUIRED WHEN INSTALLING INSTAGREEN SEDUM CARPET OR TILE.

	<p><b>GARDEN ROOF ASSEMBLY</b></p>
<p><b>AMERICAN HYDROTECH, INC.</b></p>	

<p>TYPICAL TOP OF SLOPE GARDNET WALL/CURB CONNECTION (WITH DOW INSULATION)</p>	
<p>NO SCALE</p>	<p>GN-5A</p>